

Fire Rated Wood Moulding

The global leader in
door opening solutions

July 12, 2017

ASSA ABLOY Wood Doors is pleased to announce enhancements to the Fire Rated Wood Moulding offering. 90 minute fire rated doors can now be provided with lites up to 1296 in². Listed and Labeled 1/4" wired glass (up to 100 in²) or Listed and Labeled 3/16" ceramic glass may be used with the Fire Rated Wood Moulding. To order the wood wrapped composite moulding use order code "MF3" in column 11 of the Graham Wood Door order form for "Moulding".

Product was successfully tested per WDMA TM-7 to the Extra Heavy Duty requirements of WDMA I.S. 1A.

45 to 90 Minute Available Sizes:

Maximum visible area: 1296 in²
Maximum visible width: 36 inches
Maximum visible length: 54 inches

Standard Species Available:

Red Oak
Natural Birch
White Maple
Cherry
Mahogany
Black Walnut

Other species are available upon request. Contact your ASSA ABLOY Wood Door customer service professional for more details.



WOOD DOORS

Graham | Maiman

www.assaabloywooddoors.com

July, 2017

Fire Rated Flush Wood Moulding for Lites

1. Available with 45, 60 and 90 minute fire rated (mineral core) doors.

Hourly Rating	Area (in ²)	Width (inch)	Height (inch)	Distance from Lite Cutout to:			
				Multiple Lites	Door Edge (inch)	Hardware Prep Cutout (inch)	Lite Cutouts (inch)
45-90 Minute*	1296	36	54	Yes, sum of areas ≤ 1296 in ²	5	1.313	5

2. Factory installed: glass, glazing material, glazing bead, clips, nails, provided.
3. Flush Moulding Profile: **MF3**
4. Available Species: Red Oak, Natural Birch, White Maple, Cherry, Mahogany, and Walnut. Contact your Customer Service Professional for availability of other species.
5. Glass: 1/4" thick nominal wired glass (100 in² maximum) or 3/16" thick nominal ceramic (1296 in² maximum)
6. Cutout Size and Glass Size:
 - Cutout Width = Visible Glass Width + 1.500"
 - Cutout Height = Visible Glass Height + 1.500"
 - Glass Width = Visible Glass Width + 1.375"
 - Glass Height = Visible Glass Height + 1.375"

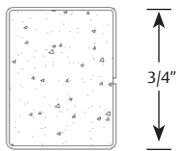

MF3

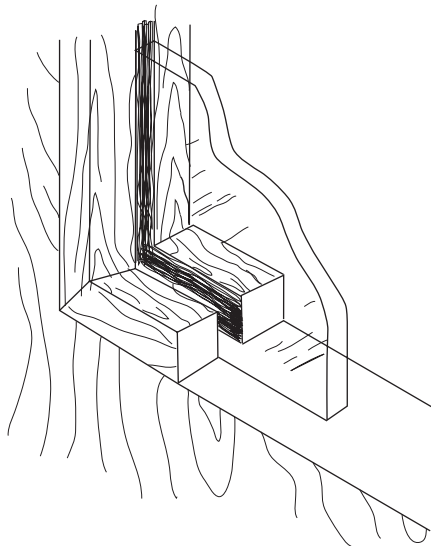

A variance in the downset of flush mouldings may occur due to allowable tolerance deviations of components.

*The International Building Code (IBC) states that fire protection rated glazing in excess of 100 in² is not permitted in 60 and 90 minute fire rated doors. NFPA 80 states that glazing materials in vision panels shall be installed in accordance with inspection service procedure and under label service.